

## 1983 KDX™250 PARTS DIAGRAM

AIR CLEANER

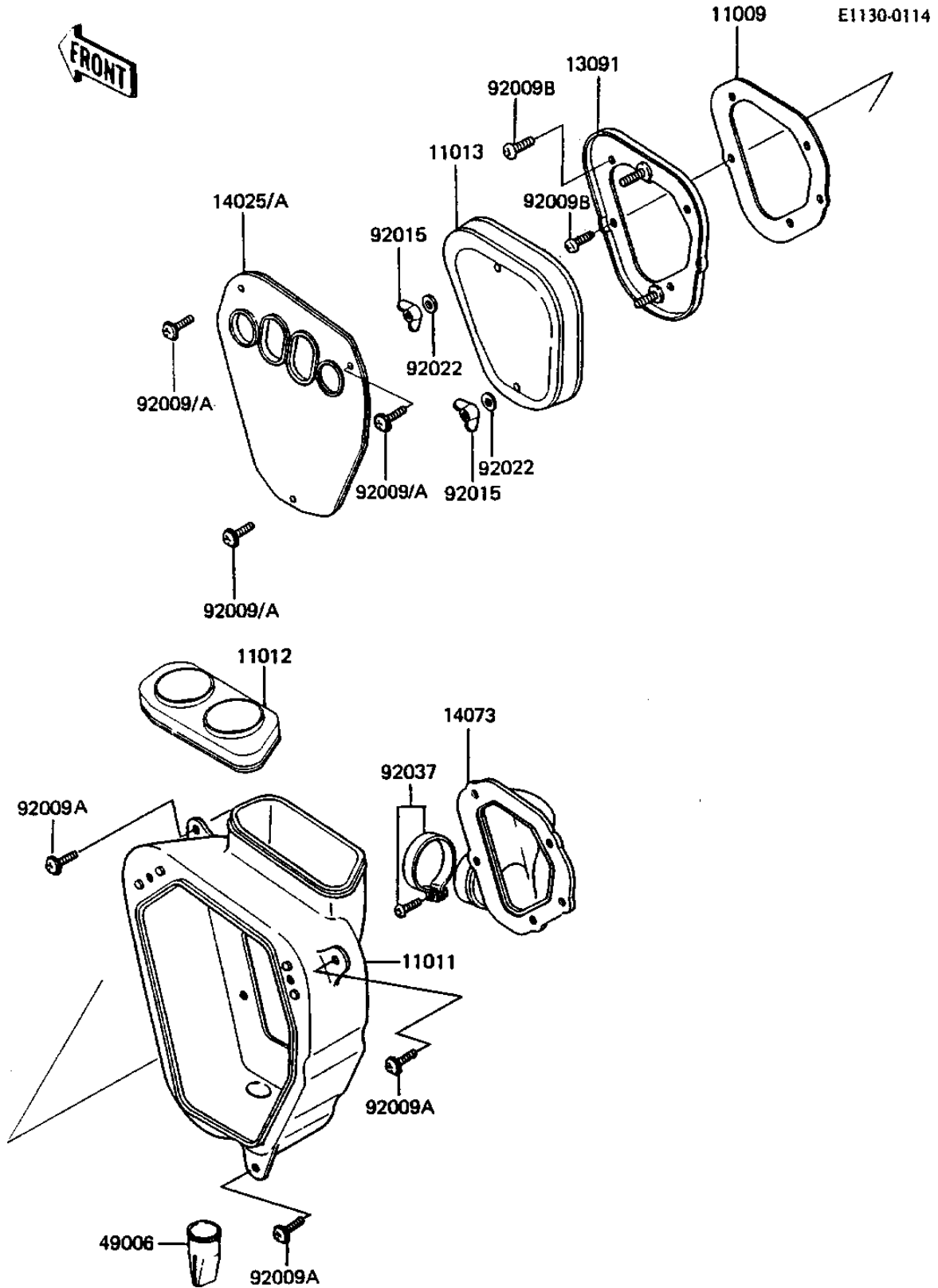

## 1983 KDX™250 PARTS LIST

### AIR CLEANER

| ITEM NAME                           | PART NUMBER | QUANTITY |
|-------------------------------------|-------------|----------|
| GASKET,AIR FILTER CAS (Ref # 11009) | 11009-1317  | 1        |
| CASE-AIR FILTER (Ref # 11011)       | 11011-1125  | 1        |
| CAP,AIR FILTER CASE (Ref # 11012)   | 11012-1199  | 1        |
| ELEMENT-AIR FILTER (Ref # 11013)    | 11013-1071  | 1        |
| HOLDER,AIR FILTER ELE (Ref # 13091) | 13091-1162  | 1        |
| COVER,AIR FILTER CASE (Ref # 14025) | 14025-1386  | 1        |
| DUCT,AIR FILTER (Ref # 14073)       | 14073-1096  | 1        |
| BOOT (Ref # 49006)                  | 49006-1012  | 1        |
| SCREW,6X14 (Ref # 92009A)           | 92009-1287  | 1        |
| SCREW,5X12 (Ref # 92009B)           | 92009-1296  | 1        |
| NUT,AIR CLEANER CAP (Ref # 92015)   | 92016-062   | 1        |
| WASHER 6.5X20X1.6T (Ref # 92022)    | 92022-125   | 1        |
| CLAMP-AIR CLEANER (Ref # 92037)     | 92037-068   | 1        |