

1980 750 Standard-4 PARTS DIAGRAM

CLUTCH ('80 KZY 50-E1)

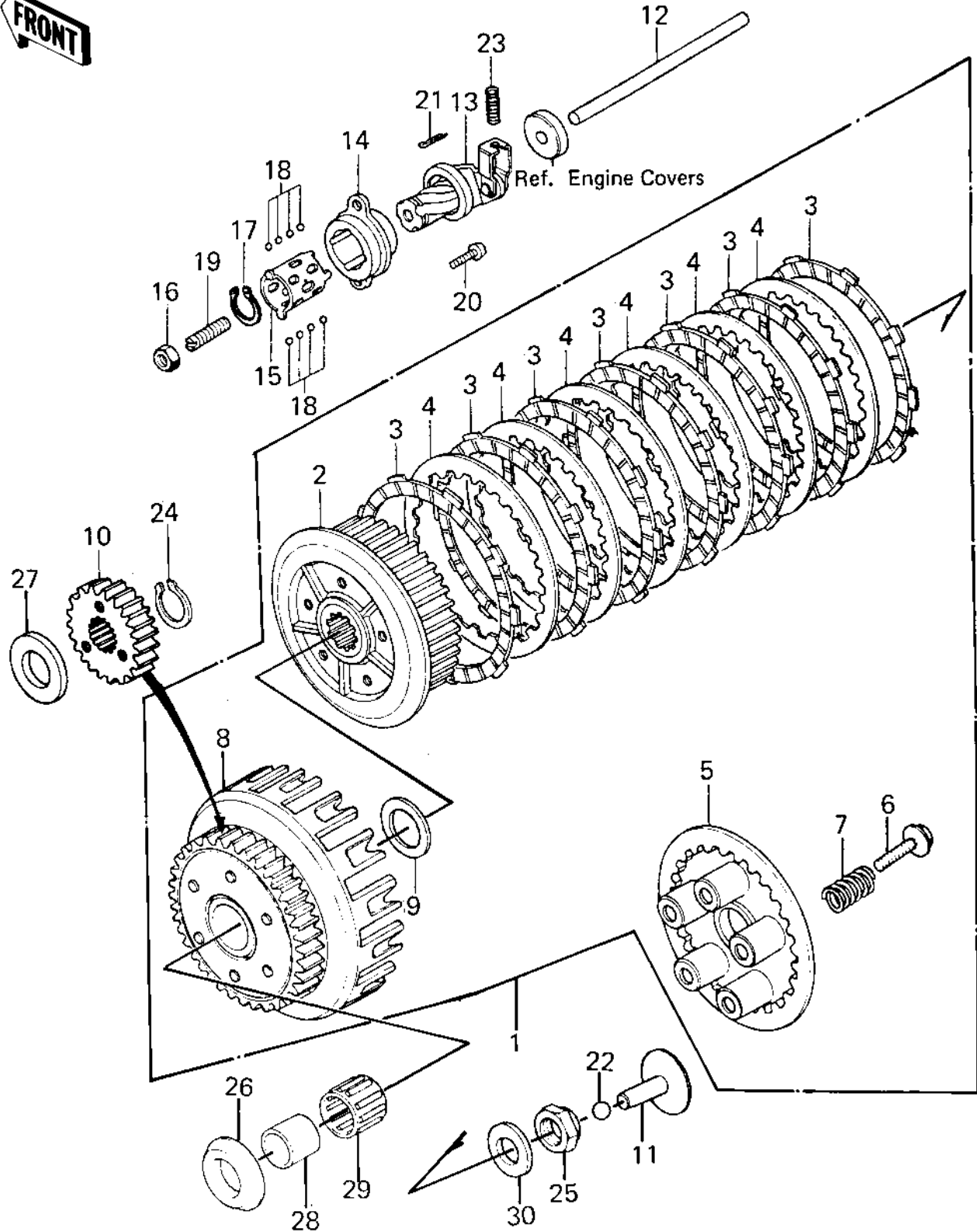

1980 750 Standard-4 PARTS LIST

CLUTCH ('80 KZY 50-E1)

ITEM NAME	PART NUMBER	QUANTITY
CLUTCH-ASSY (Ref # 1)	13081-1034	1
HUB,CLUTCH (Ref # 2)	13087-043	1
PLATE,CLUTCH FRICTION (Ref # 3)	13088-030	1
PLATE,CLUTCH STEEL (Ref # 4)	13089-022	1
PLATE,CLUTCH SPRING (Ref # 5)	13187-006	1
BOLT,CLUTCH SPR FITT (Ref # 6)	92001-1066	1
SPRING,CLUTCH (Ref # 7)	92081-1176	1
HOUSING,CLUTCH (Ref # 8)	13095-1033	1
WASHER TH 25.5X47X2.5 (Ref # 9)	92026-022	1
GEAR,2ND SHAFT,29T (Ref # 10)	13121-037	1
PUSHER,CLUTCH SPRG PL (Ref # 11)	13116-022	1
ROD,CLUTCH PUSH (Ref # 12)	13116-1007	1
INNER,CLUTCH RELEASE (Ref # 13)	13102-027	1
OUTER,CLUTCH RELEASE (Ref # 14)	13118-011	1
RETAINER (Ref # 15)	13197-004	1
NUT 8MM (Ref # 16)	318B0800	1
CIRCLIP 15MM (Ref # 17)	480J1500	1
BALL,STEEL,1/8" (Ref # 18)	600A0400	1
SCREW,SLOTTED,8X25 (Ref # 19)	92014-014	1
SCREW PAN HEAD 6X16 (Ref # 20)	220B0616	1
PIN COTTER 1.6X15 (Ref # 21)	550D1615	1
BALL STEEL 3/8" (Ref # 22)	600A1200	1
SPRING-CLUTCH RELEASE (Ref # 23)	92081-069	1
CIRCLIP,22MM (Ref # 24)	480J2200	1
NUT,20MM (Ref # 25)	92015-1555	1
SPACER,THRUST,T=5.5MM (Ref # 26)	92026-116	1
COLLAR,T=5MM (Ref # 27)	92027-263	1
BUSHING,CLUTCH (Ref # 28)	92028-178	1
BEARING,KTV323723 (Ref # 29)	92046-028	1

1980 750 Standard-4 PARTS LIST

CLUTCH ('80 KZY 50-E1)

ITEM NAME	PART NUMBER	QUANTITY
WASHER (Ref # 30)	92125-002	1