

1972 PARTS DIAGRAM

HEADLIGHT ('72-'73 F9/F9-A 350)

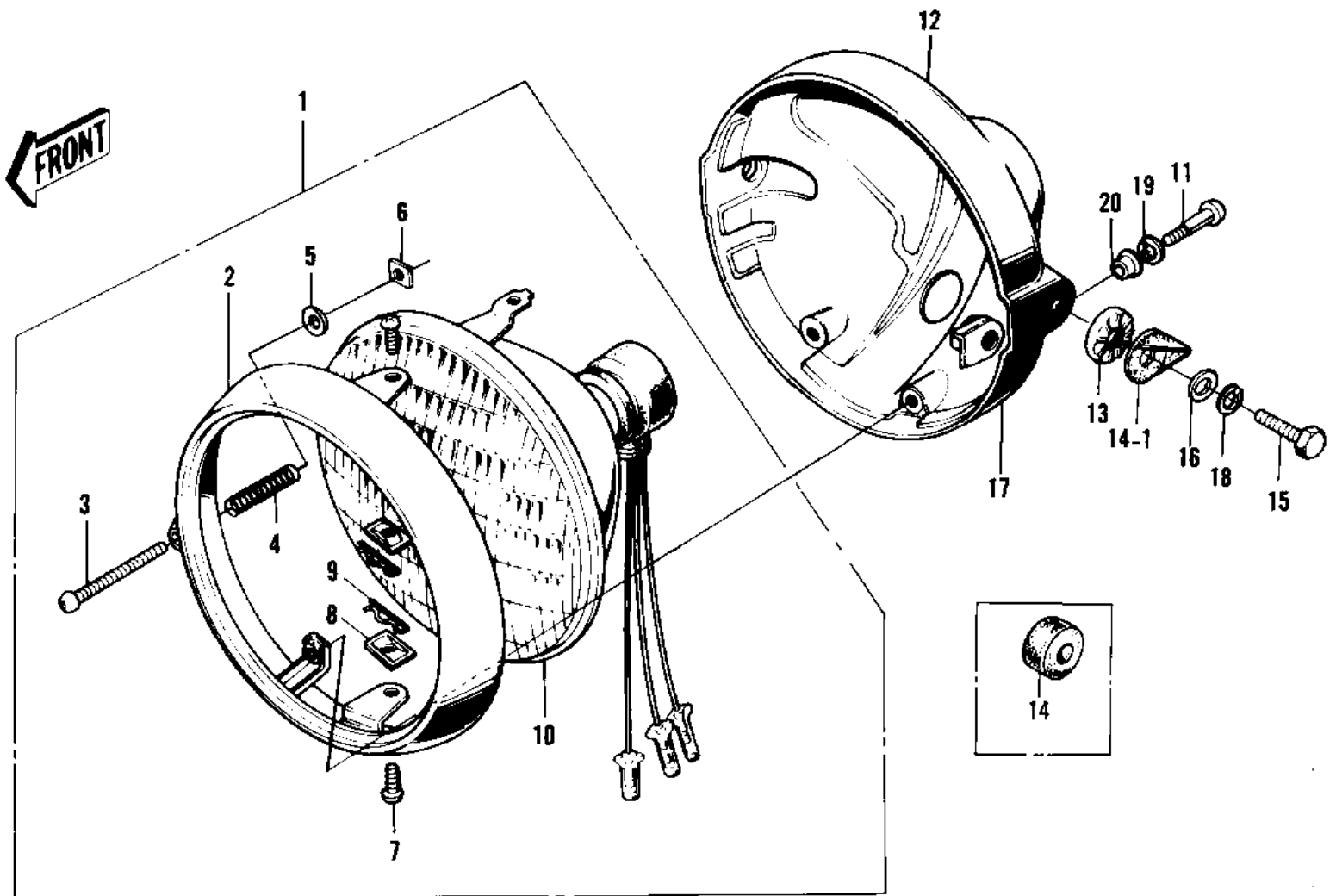

1972 PARTS LIST

HEADLIGHT ('72-'73 F9/F9-A 350)

ITEM NAME	PART NUMBER	QUANTITY
LAMP UNIT-HEAD (Ref # 1)	23003-015	1
.RIM-HEAD LAMP (Ref # 2)	23006-028	1
.SCREW FORCUS ADJUST (Ref # 3)	23019-021	1
.SPRING FOCUS ADJUST (Ref # 4)	23014-005	1
.WASHER (Ref # 5)	23021-004	1
.NUT (Ref # 6)	23020-016	1
.SCREW LENS UNIT FITT (Ref # 7)	23019-018	1
.NUT LENS UNIT FITTIN (Ref # 8)	23020-009	1
.PIN LENS UNIT FITTIN (Ref # 9)	23022-001	1
.LENS UNIT-HEAD LAMP (Ref # 10)	23007-032	1
SCREW-PAN HEAD,5MM (Ref # 11)	92011-024	1
BODY-HEAD LAMP,BLACK (Ref # 12)	23005-034-10	1
WASHER-LOCK (Ref # 13)	23021-011	1
DAMPER RUBBER (Ref # 14)	92075-079	1
DAMPER RUBBER (Ref # 14-1)	92075-134	1
BOLT,10MM (Ref # 15)	92007-024	1
WASHER-PLAIN,10MM (Ref # 16)	411D1000	1
NUT (Ref # 17)	23020-017	1
WASHER SPRING 10MM (Ref # 18)	461F1000	1
WASHER SPRING 5MM (Ref # 19)	461F0500	1
WASHER (Ref # 20)	23021-010	1