

1983 KX™60 PARTS DIAGRAM

IGNITION COIL

E1830-0130

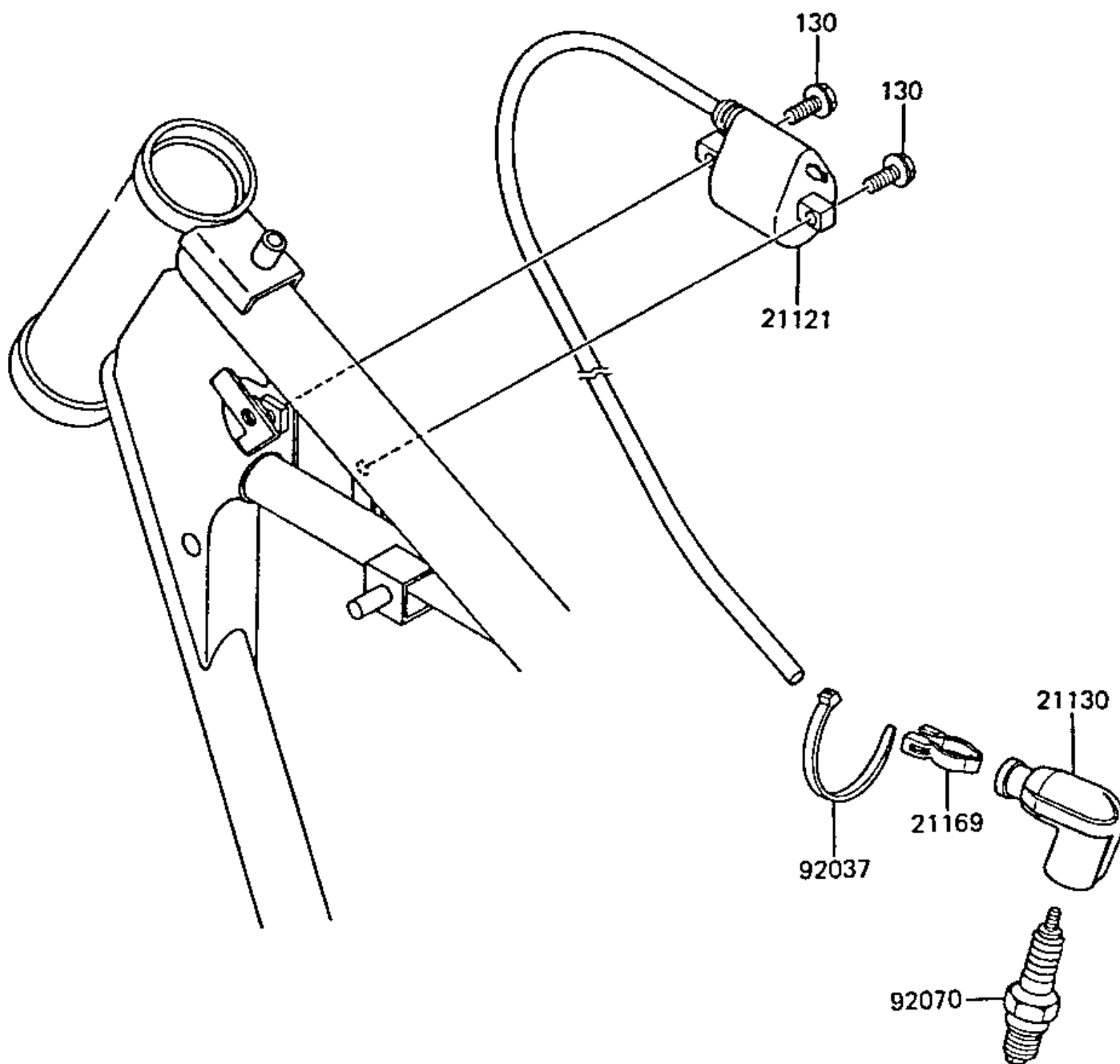

1983 KX™60 PARTS LIST

IGNITION COIL

ITEM NAME	PART NUMBER	QUANTITY
COIL-IGNITION (Ref # 21121)	21121-1057	1
CAP,SPARK PLUG (Ref # 21130)	21130-1006	1
TERMINAL,PLUG CAP (Ref # 21169)	21169-001	1
CLAMP,SPARK PLUG CAP (Ref # 92037)	92037-1173	1
SPARK PLUG B9ES (Ref # 92070)	B9ES	1
BOLT-FLANGED,6X16 (Ref # 130)	130G0616	1