

# ALTERNATOR KIT (99999-0283)

## ASSEMBLY INSTRUCTIONS

### 1. PART LIST

Ref.	Parts Number	Component Name	Qty	Remarks
1	11048-1243	BRACKET	1	
2	11048-1244	BRACKET	1	
3	130BA0820	BOLT-FLANGED	10	D=8 mm, L=20 mm
4	130BB0608	BOLT-FLANGED	2	D=6 mm, L=8 mm
5	14090-1362	COVER	1	
6	14091-1377	COVER	1	
7	21001-1129	GENERATOR	1	
8	26011-1586	WIRE-LEAD	1	
9	461DA0800	WASHER-SPRING	3	D=8.2 × 15.4 mm
10	59011-2056	BELT	1	
11	59091-2054	PULLEY	1	
12	92001-1522	BOLT	1	D=10 mm, L=47 mm
13	92015-1367	NUT	1	D=6 mm
14	92072-1195	BAND	3	
15	92200-1055	WASHER	3	D=8.5 × 20 mm,

### 2. BEFORE ASSEMBLY

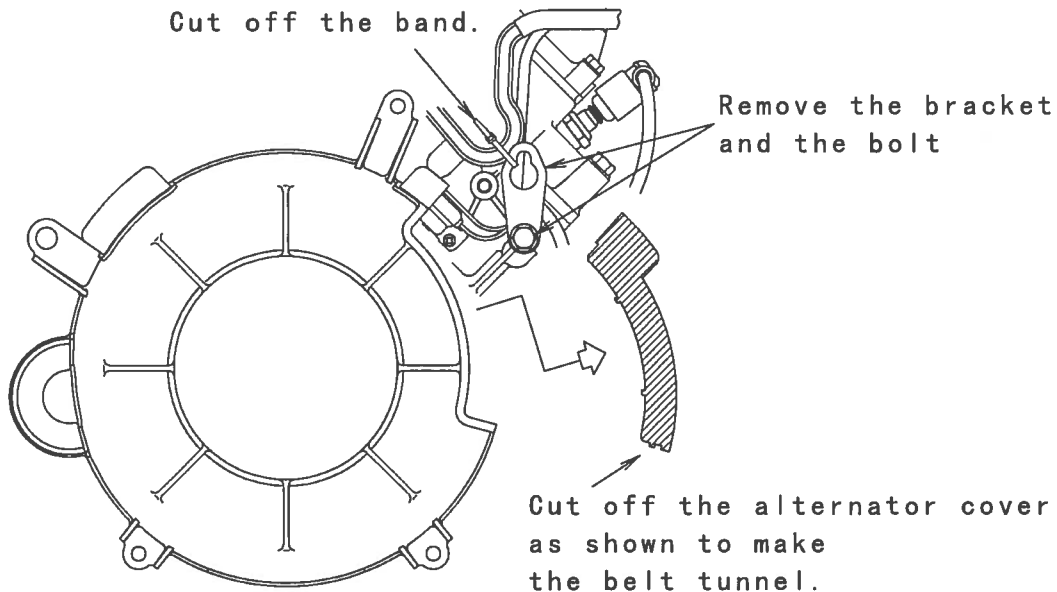

S106967BW2 C

**3. ASSEMBLY**

(Viewed from Right)

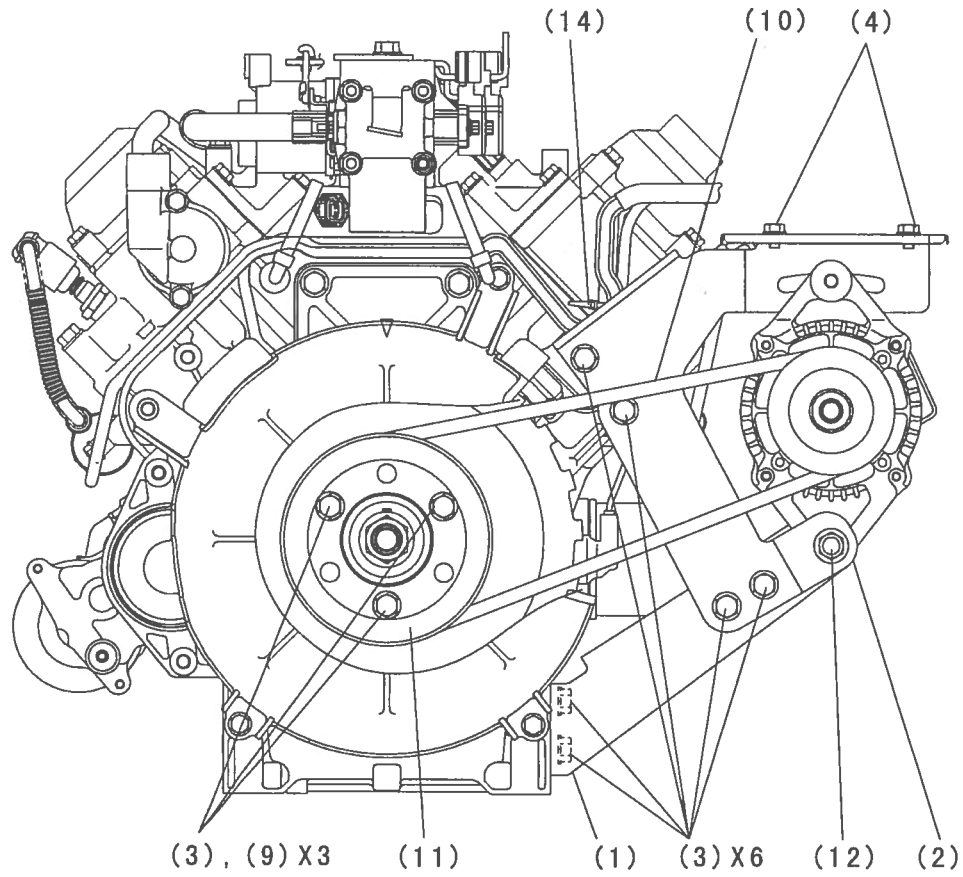

S108968W3 C

(Viewed from Top)

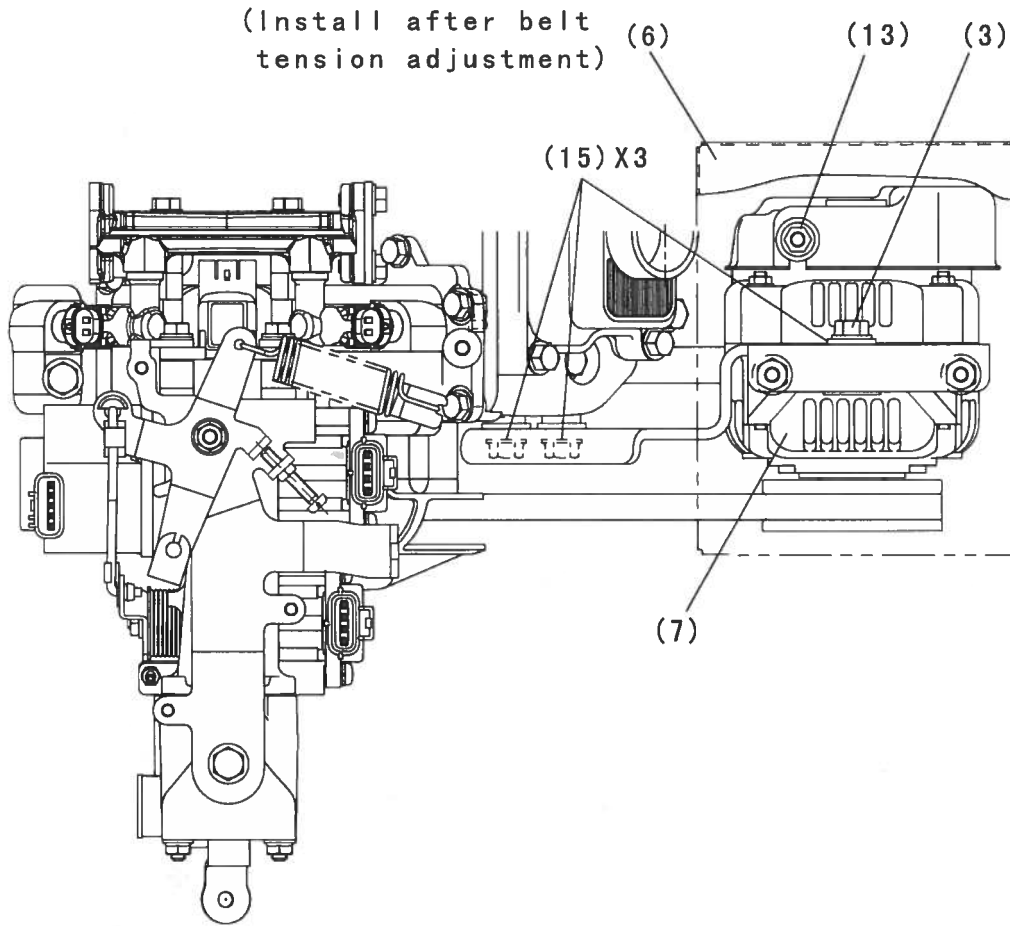

S106968W3 C

#### 4. SERVICE SPECIFICATIONS

##### Tightening Torque

Ref.	Part Number	Part Name	Torque
3	130BA0820	BOLT-FLANGED	20 N·m (2.0 kgf·m, 15 ft·lb)
4	130BB0608	BOLT-FLANGED	4.4 N·m (0.45 kgf·m, 39 in·lb)
12	92001-1522	BOLT	34 N·m (3.5 kgf·m, 25 ft·lb)
13	92015-1367	NUT	4.4 N·m (0.45 kgf·m, 39 in·lb)

##### Belt Tension

Push the belt lightly between the pulleys.  
The deflection of the belt must be approximate 7 mm

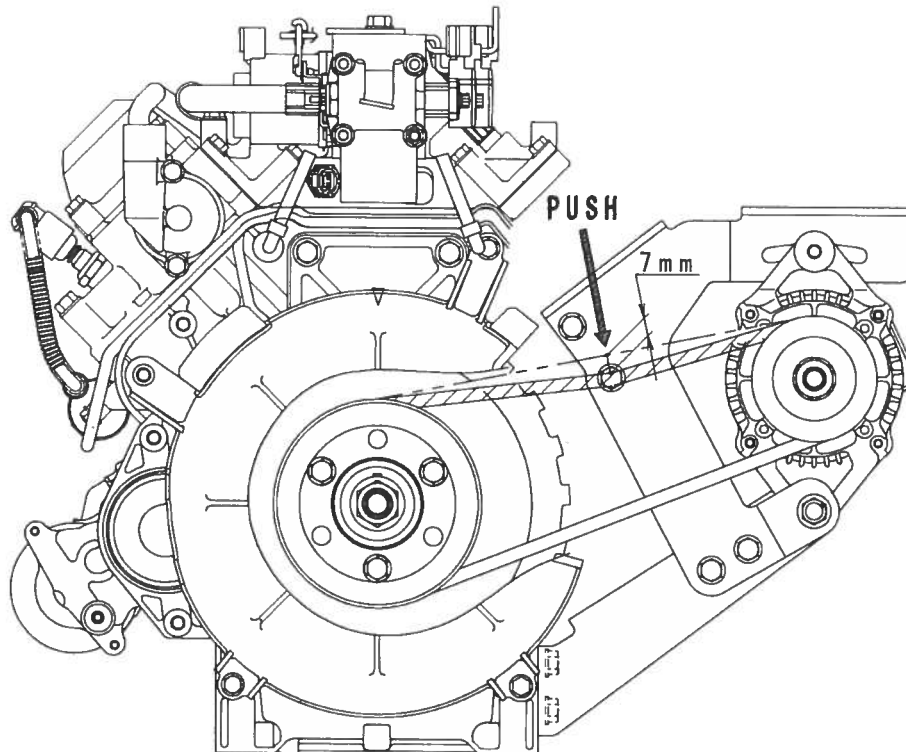

S106970BW3 C

## 5. BELT TENSION ADJUSTMENT

1. Before assembling the alternator kit parts except for the cover [6] and tightening the bolts and nut to the specified torque, loosen the bolts [A] and [12].
2. Move the alternator using a lever [B] until the proper belt tension is obtained.
3. Keeping the alternator position, tighten the bolt [A] and then the bolts [12] to the specified torque.
4. Install the cover [6] and tighten the bolts [4] to the specified torque.

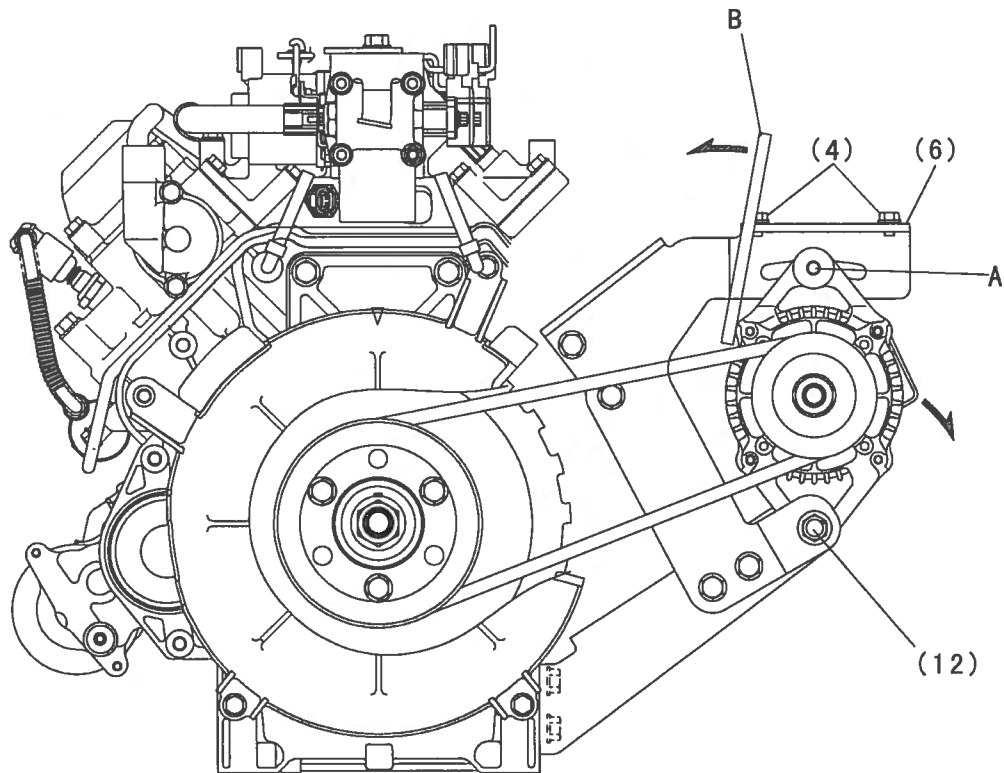

S106971BW3 C

## 6. WIRE ROUTING

(Viewed from Top)

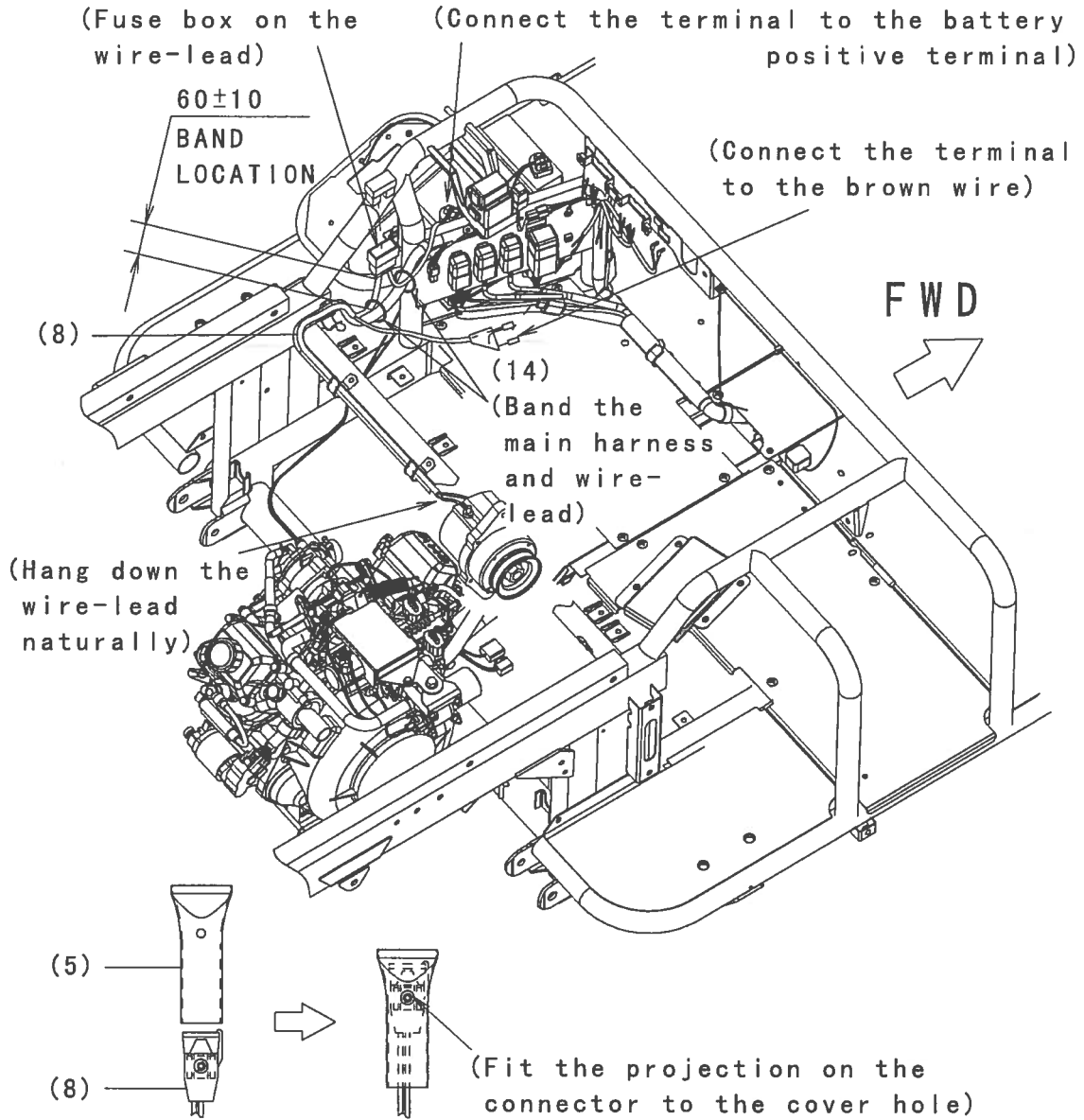

S106972B/4 C

**7. WIRING DIAGRAM**

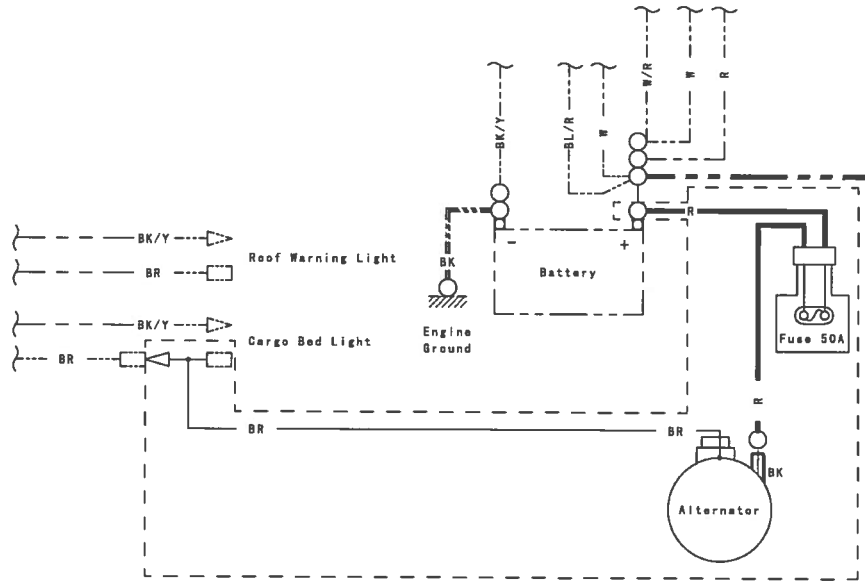

S106973BW2 C