

Assembly Instructions

Model:	ZX1400H/J
Description:	Center Stand
Part Number:	99994-0751

Before you begin, read through these instructions and check that all parts are present. Please note that Kawasaki cannot assume any responsibility for damage resulting from incorrect installation.

Kawasaki recommends that all genuine accessories should be fitted by an authorized Kawasaki dealer.

The following symbols indicate the information for proper installation and operation in this instruction.

NOTE : NOTE indicates information that may help or guide you in the operation or service of the vehicle.

● Indicates a procedural step or work to be done.

○ Indicates a procedural sub-step or how to do the work of the procedural step it follows. It also precedes the text of a NOTE.

Refer to the Service Manual (P/No.: 99924-1508-01) for detailed procedures.

Parts List				
No.	Component Name	Part No.	Qty	Remark
1	Bolt	92153-1593	2	M10 × 54.2
2	Nut	92210-0278	2	
3	Bracket	11054-0744	1	
4	Bolt	92154-1867	2	M6 × 16
5	Spring	92145-0362	1	
6	Tube	92190-1462	1	
7	Center Stand	34011-0061	1	
8	Grip	32109-0021	1	
9	Bracket	11054-0452	1	
10	Collar	92152-0668	1	
11	Bolt	92153-1524	1	M10 × 30
12	Bracket	11056-1820	1	
13	Bolt	130BA0625	2	M6 × 25
14	Clamp	92173-0848	1	
15	Bracket	11056-1819	1	
16	Bolt	120CA0630	1	M6 × 30
17	Gasket	11061-0448	2	
18	Damper	92075-015	1	
19	Nut	92210-0316	3	

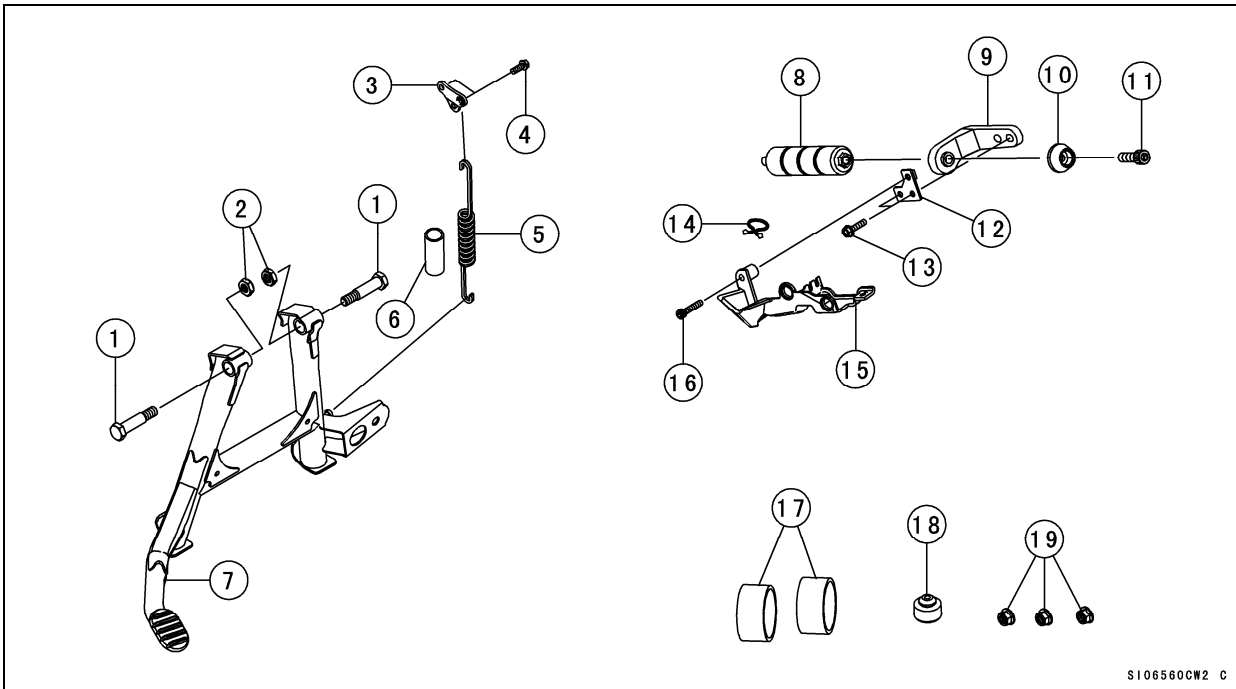

S106560CW2 C

Installation Instructions

- Remove:
 - Left Seat Cover (Refer to the Service Manual)
 - Bolts [A]
 - Seat Lock Cable Cover [B]

NOTE

- The removed seat lock cable cover and bolts are necessary for this accessory.

- Remove the clip [A].
- Detach the seat lock cable ends [B], and remove the seat lock cables from the seat lock bracket [C].
- Remove the seat lock [D] from the seat lock bracket.

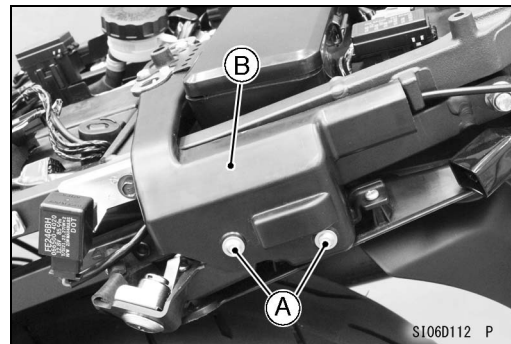

S106D112 P

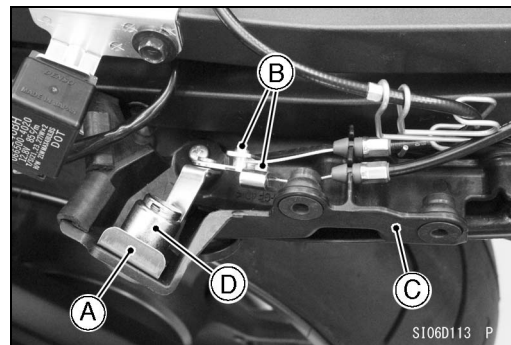

S106D113 P

- Remove:
 - Seat Lock Bracket Bolt [A]
 - Seat Lock Bracket Screws [B]
 - Seat Lock Bracket [C]

NOTE

- The removed seat lock bracket screws are necessary for this accessory.
- The removed seat lock bracket and seat lock bolt are not necessary for this accessory.

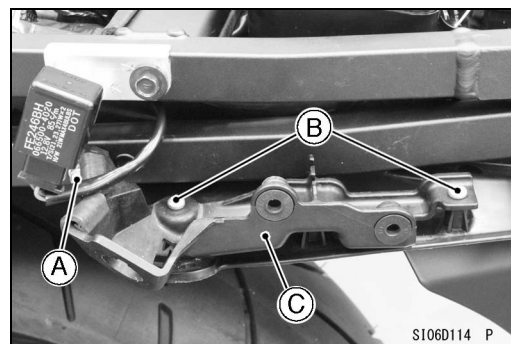

S106D114 P

- Remove the trim [A] and wellnuts [B] from the seat lock bracket.

NOTE

- *The removed trim and wellnuts are reused for this accessory.*
- *The another trim is not necessary for this accessory.*

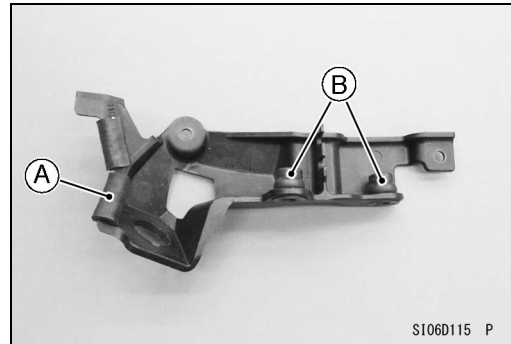

- Remove the bolt [A] and collar [B].

NOTE

- *The removed bolt and collar are not necessary for this accessory.*

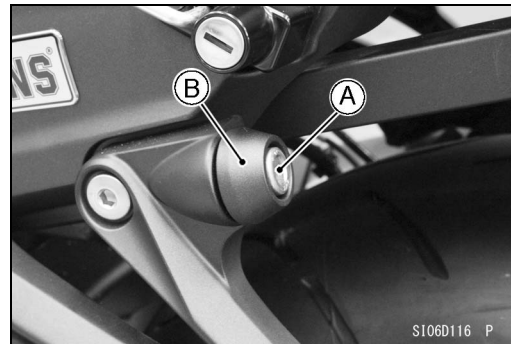

- Install the grip [8] securely.



- Install the following parts temporarily.

- Bracket [9]
- Collar [10]
- Bolt [11]

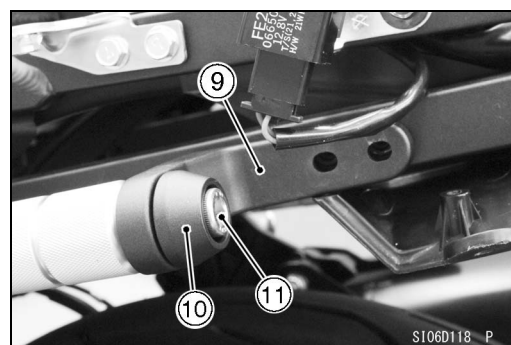

- Install the bracket [12] and tighten the bolts [13] securely.
- Tighten the bolt [11] securely.

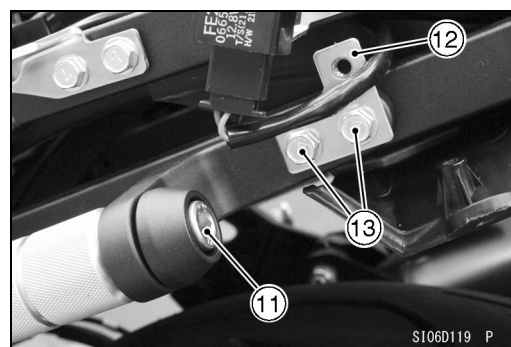

- Install the trim [A] (reused) and wellnuts [B] (reused) to the seat lock bracket [15].

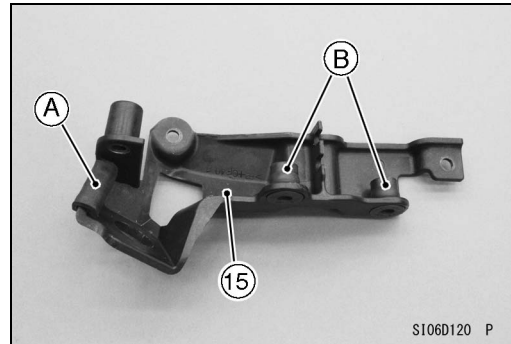

- Install the seat lock bracket [15], and tighten the seat lock bracket screws [A] (reused) securely.

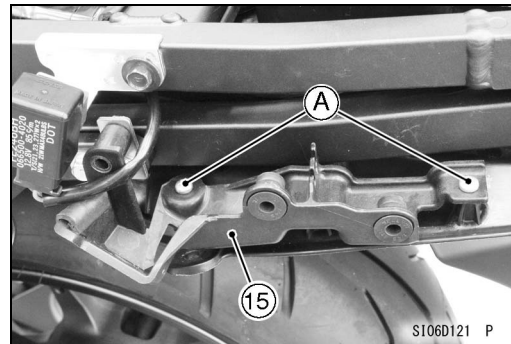

- Tighten the bolt [16].

Torque – Seat Lock Bracket Bolt: 4.0 N·m (0.41 kgf·m, 35 in·lb)

- Hold the lead with the clamp [14] as shown.

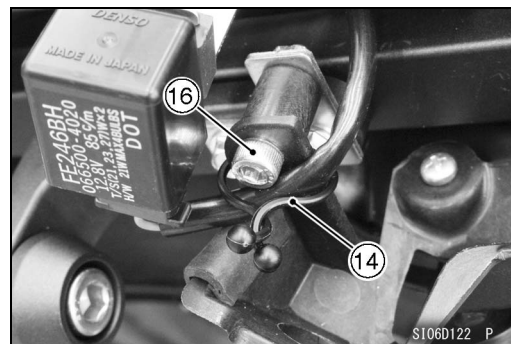

- Install the seat lock [A].
- Install the seat lock cable end [B] to the seat lock, and fit the seat lock cables to the seat lock bracket [C].
- Install the clip [D] to hold the seat lock.

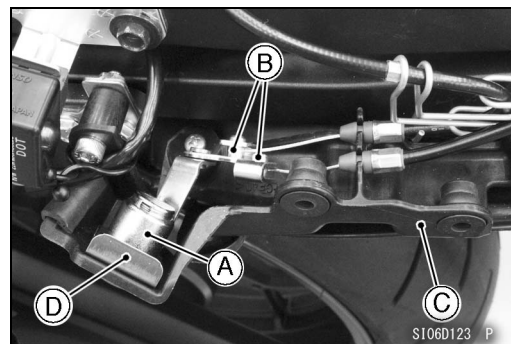

- Install the seat lock cable cover [A] (reused), and tighten it bolts [B] (reused) securely.
- Insert the cover end [C] under the seat latch bracket.
- Run the seat lock cable [D] as shown.
- Install the left seat cover (Refer to the Service Manual).

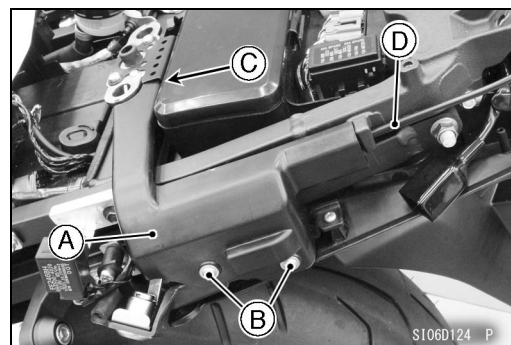

- Remove:
 - Muffler Bodies (Refer to the Service Manual)
 - Rear Lower Fairing (Refer to the Service Manual)
 - Rear Lower Fairing Bracket (Refer to the Service Manual)
- Install the bracket [3], and tighten its bolts [4] securely.
- Apply grease to the sliding area [A] of the center stand [7].
- Install:
 - Center Stand
 - Nuts [2]
 - Bolts [1]
- Tighten:
 - Torque – Center Stand Bolts: 45 N·m (4.6 kgf·m, 33 in·lb)**
- Install the tube [6] to the spring [5].
- Hook the spring so that the long spring end of it faces upward.
- Install the spring hook direction as shown.

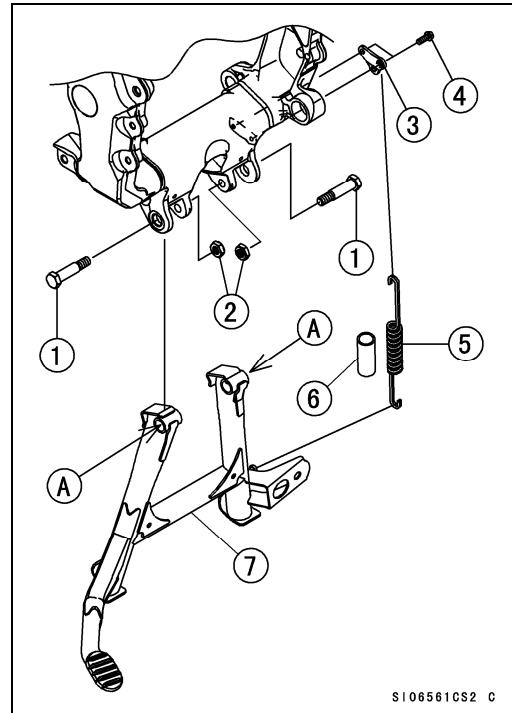

S106561CS2 C

- Install the damper [18] to the right muffler body [A].
- Install the muffler bodies (Refer to the Service Manual).
- Replace the following parts when installing the muffler bodies.
 - Gaskets [17]
 - Muffler Body Mounting Nuts [19]

NOTE

- *The rear lower fairing cannot be installed when installing the center stand.*

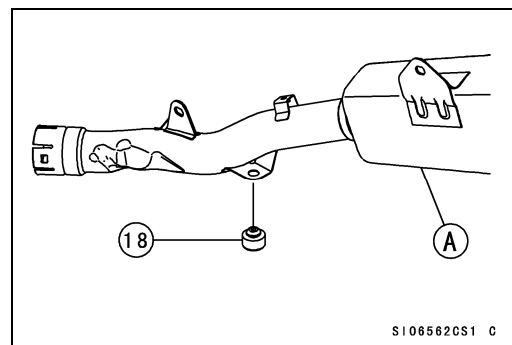

S106562CS1 C

Basic Torque for General Fasteners

The tables below, relating tightening torque to thread diameter, lists the basic torque for the bolts, nuts and screws. Use these tables for the bolts, nuts and screws which are not specified the tightening torque particularly on the previous pages. All of the values are for use with dry solvent-cleaned threads.

For Bolts and Nuts

Threads dia. (mm)	Torque		
	N·m	kgf·m	ft·lb
5	4.5	0.46	40 in·lb
6	8.0	0.82	71 in·lb
8	20	2.0	15
10	35	3.6	26
12	60	6.1	44

For Screws, Plastic Part Tightening Portions and Plastic Washer Tightening Portions

Threads dia. (mm)	Torque		
	N·m	kgf·m	ft·lb
4	1.2	0.12	11 in·lb
5	3.0	0.31	27 in·lb
6	4.0	0.41	35 in·lb

For Self-Tapping Screws

Threads dia. (mm)	Torque		
	N·m	kgf·m	ft·lb
All	1.2	0.12	11 in·lb

For Wellnuts

Threads dia. (mm)	Torque		
	N·m	kgf·m	ft·lb
4	0.2	0.02	1.8 in·lb
5	0.5	0.05	4.4 in·lb
6	1.0	0.10	8.9 in·lb

Check tightness of all fasteners in regular interval. Retighten loose fasteners.